

UNILINK® INSTALLATION INSTRUCTIONS

General

Unilink® is a revolutionary system for installing laminate floors without using glue. The panels can be simply clicked together thanks to the ingenious shape of the tongue and groove. See picture 1

1



Tools for installing the floor

For best results, it is essential that you follow the installation instructions exactly. Besides the regular tools for installing laminate floors (i.e. hammer, saw, pencil, ruler) you will also need the following accessories:

- installation kit (crowbar (pullbar), spacers (1-8 mm / 0,039"-0,315") and Unilink®-adapted tapping block)
- underlayment system (Quick•Step® screen)
- maintenance kit

The use of accessories other than the Quick•Step® accessories might cause damage to the Quick•Step® floor. In such case the warranty provided by Quick•Step® will be void. We therefore advise to use only Quick•Step® accessories as these have been especially designed and tested for the use with Quick•Step® floor panels.

Of course we also need to saw the panels. To obtain a clean cut, the pattern side should face down when you use a jigsaw or sabre saw and up for all other types of saws.

8 focus points

1. Thanks to the Unilink® system, the floor floats and is installed without glue. You can walk on the floor during and immediately after installation.
2. Check all panels in daylight before and during installation. Defective panels must never be installed.
3. The floor should preferably be installed parallel to how the light enters the room. The ideal conditions are 15-20°C (59-68°F) at a relative humidity of 50-60%.
4. Let the panels acclimatize for 48 hours in the unopened packaging at the normal room temperature, in the middle of the room where the floor is to be installed.
5. Room humidity can vary according to the season, so it is vital that the floor is able to expand and contract. For this reason, make sure you leave an expansion gap of minimum 8 to 10 mm (5/16" to 3/8") on all sides of the floor, around pipes, thresholds, under doors and around any fixed / stationary objects (floor vents, kitchen islands, etc...)
6. Large rooms must have expansion gaps every 13 m (40 feet) width- and length- wise. It is recommended to provide an expansion gap between different rooms (e.g. under the door). Expansion gaps can be finished by means of a T-molding that is attached to the subfloor.
7. Ensure that the end gaps of the panels in two successive rows are never in line. Always ensure that the gaps are staggered by at least 10 cm / 4 inches.
8. We recommend you purchase a few extra cartons of flooring. This will be useful to you if you have some damaged pieces, miscalculate the size of the room or miss cut some pieces. This also will help you if your floor needs a repair but your product is no longer manufactured.

Preparing the room

- Check that the doors can still open and close after the floor and underlayment have been installed (minimum + 1 cm (3/8"))
- Check whether the old molding can be removed. You can also leave the wall base and finish the floor with Quick•Step® profiles.
- Make sure the subfloor is flat. Any unevenness greater than 2 mm (1/16") over the length of 1 meter (40") must be smoothed out.
- Make sure the subfloor is clean and dry:

CONCRETE SUBFLOOR

New Construction:

- A new concrete floor must dry at least 1 week per 1 cm (3/8") thickness up to 4 cm (1-1/2"). Thicknesses over 4 cm (1-1/2") require twice as much drying time. For example, a 6 cm (2-1/2") concrete subfloor must dry for at least 8 weeks. The moisture content must be less than 2.5% (CM method) or less than 5 lbs/24 hours per 1000 sqft (Calcium chloride method ASTM 1869).
- If there is underfloor heating, the subfloor must not exceed 28°C (84°F) and the moisture content must be less than 1.5% (CM method). You do need to follow special installation instructions. Please ask your dealer for more information.

Renovation:

- Remove any damp-open floor covering (carpet, needle felt, etc.) first.
- Damp-sealed floor covering (PVC, linoleum, VCT, etc.) does not have to be removed.

WOODEN SUBFLOOR

- Remove any existing floor covering first.
- Make sure the plank floor is stable. Nail down any loose parts and apply a levelling layer (Quick•Step® foam underlay) if necessary.
- Install the Unilink® panels crosswise to the direction of the existing subfloor.
- It is necessary that the crawl space under the plank floor is sufficiently ventilated. Remove any obstacles and provide sufficient ventilation (minimum 4 cm² of total ventilation holes per meter (40") of floor). The moisture content of the wood may not exceed 12%.

Installing the floor

- First install the Quick•Step® Screen underlayment, per width and gradually as you progress. Let the membrane run up the wall a bit before cutting to size.

With Unilink® the first floorstrip is affixed to the underfloor panel. The two other strips are clicked into the first strip. First slide the strips, then cut the panel as on **picture 2-3-4-5-6**.

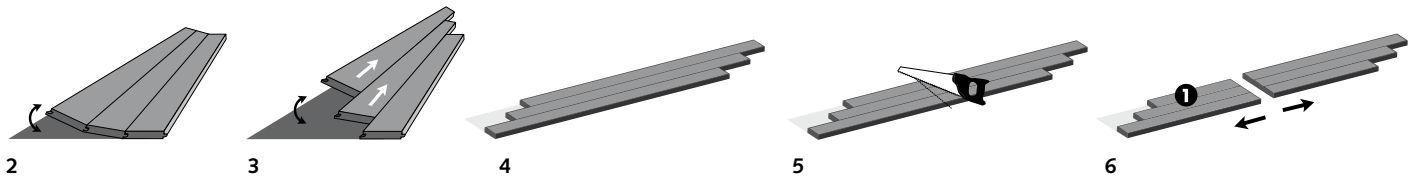

Begin the first row with the panel as in **picture 7**. Don't forget to saw off the tongues of the first strips of the first row.

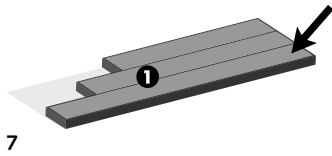

Click the second panel with the first strip in the first strip of the already installed panel. Make sure that the strips are in line. Follow **pictures 8 (A-B), 9 (C-D-E-F-G-H-I-J), 10, 11, 12, 13**.

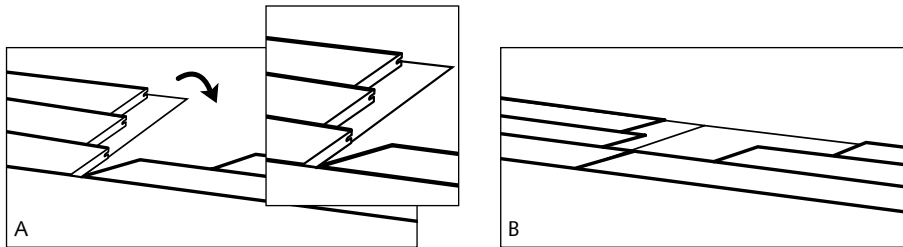
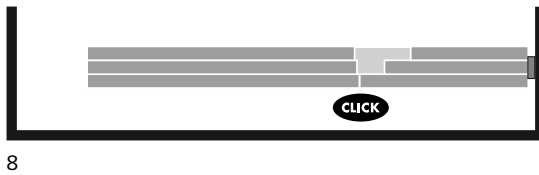

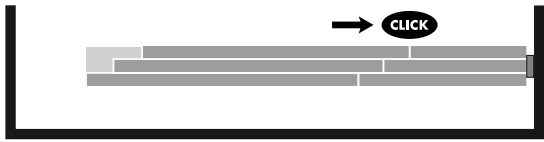

9

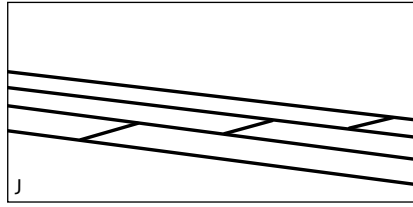
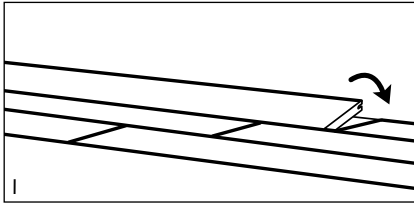
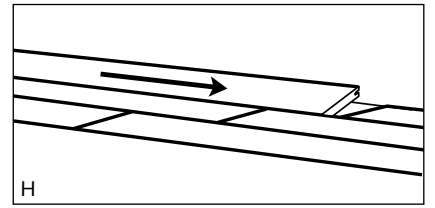
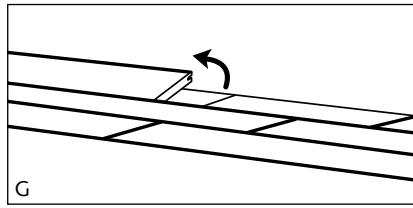
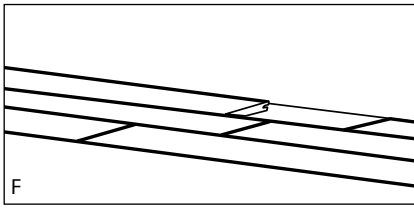
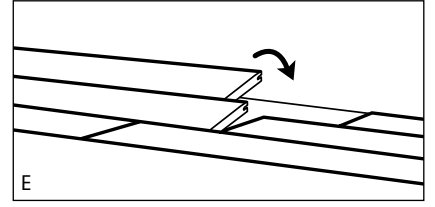
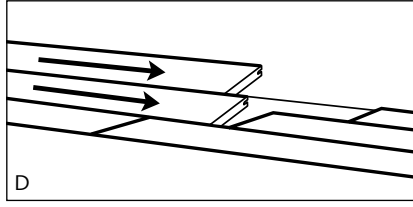
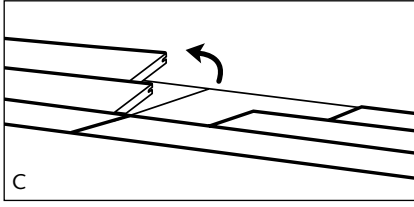

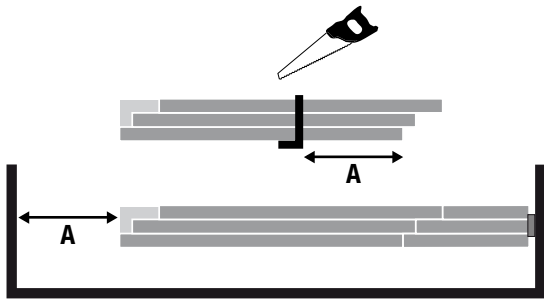

10



11



12



13

Start to cut a new panel for the second row in a different staggering as the first one. Start the third row with the remainder of the first row. Follow picture 14.



14

Push this part of the installed floor with sawn off sides against the walls. Put spacers from the installation kit between the panels and the wall. This will ensure that your expansion gap is wide enough: 8 to 10 mm (5/16" to 3/8"). See pictures 15 and 16. There must also be an 8 to 10 mm (5/16" to 3/8") expansion gap between the last row and the wall. Keep this in mind when sawing the last row of panels



15



16

Pipes

In rows where there is a pipe, try to make sure the pipe falls exactly in line with the short side of two panels. Take a drill bit with the same diameter as the pipe plus 20 mm (3/4") for the expansion. Click the panels together on the short side and drill a hole centered on the gap between the two panels. Now you can install the panels in the floor. See Pictures 17, 18 and 19.

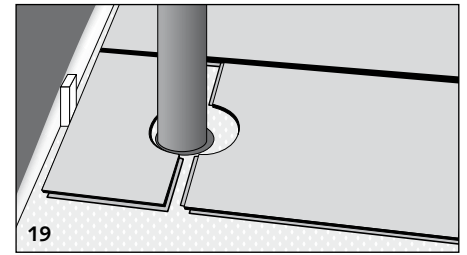
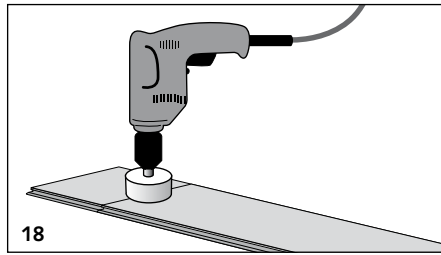
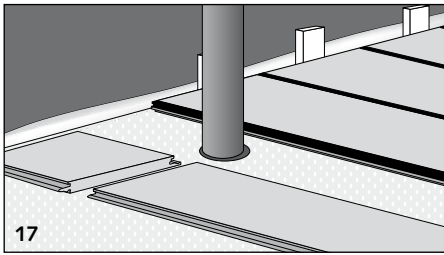

Under doorframes

When sawing the panels ensure that the expansion joint under the door is at least 10 mm (3/8"). If you cannot lift the panel, use an adapted tapping block and hammer to tap the panels together with the planks flat on the floor. See pictures 20 and 21.

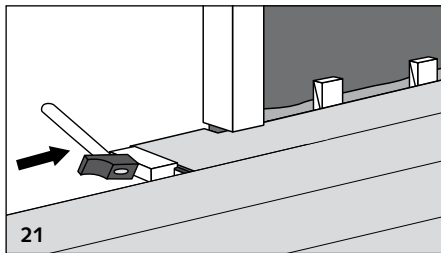
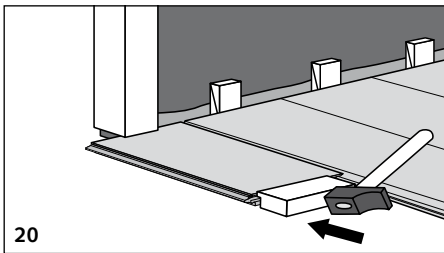

Finishing

- Remove all spacers.
- Install the molding. Never attach the molding to the floor.
- This method allows the floor to expand and contract under the molding.
- For a perfect finish around pipes, use rosettes or Quick•Step® kit.
- In places where profiles or skirting cannot be placed, fill expansion gaps with Quick•Step® kit. See picture 22.

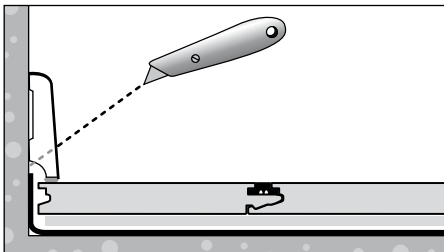

Precautions

- Protect furniture and chair legs with proper felt or plastic caps.
- Avoid bringing dirt, water and sand indoors by providing a suitable floor mat at all outside doors.
- Use (office) chairs and seats with soft wheels that are suitable for a laminate floor and/or use a suitable desk mat.
- Ensure that humidity in the room is always at least 50%. Use a humidifier if you need to.

Maintenance

- The smooth surface of your laminate means it never retains dirt or dust.
- Never use wax or varnish coating on the floor.
- For dry maintenance, we recommend a Quick•Step® duster (flipper) or vacuum cleaner.
- For slightly damp maintenance, we advise the Quick•Step® maintenance set (see instructions). Be aware that the use of other cleaning products might damage your floor. Always wipe dry immediately until no more moisture is visible on the floor. We strongly recommend dry cleaning only for beveled edge products. Wet maintenance is absolutely forbidden. Remove any water immediately. Unilink® panels are not suitable for use in damp spaces like bathrooms and saunas.
- To remove stubborn stains we recommend Quick•Step® Force or acetone. Never use scouring products!

Enjoy your floor.